

Date:	No:	Page:
04.04.2019	SB2019-06	1 of 3

Applies to:		Bulletin subject:
WTD	X	PRESSURE OIL FILTER REBUILDING KIT
SAFETY WINDOWS		
AUTOMATION		
Created by:		GDA
Approved by:		KRM

REBUILDING FOR PRESSURE OIL FILTER OUTSIDE POWER PACK

Part number 10051816 Pressure Oil Filter, Rebuilding Kit
Part number 10022320 Filter for replacement

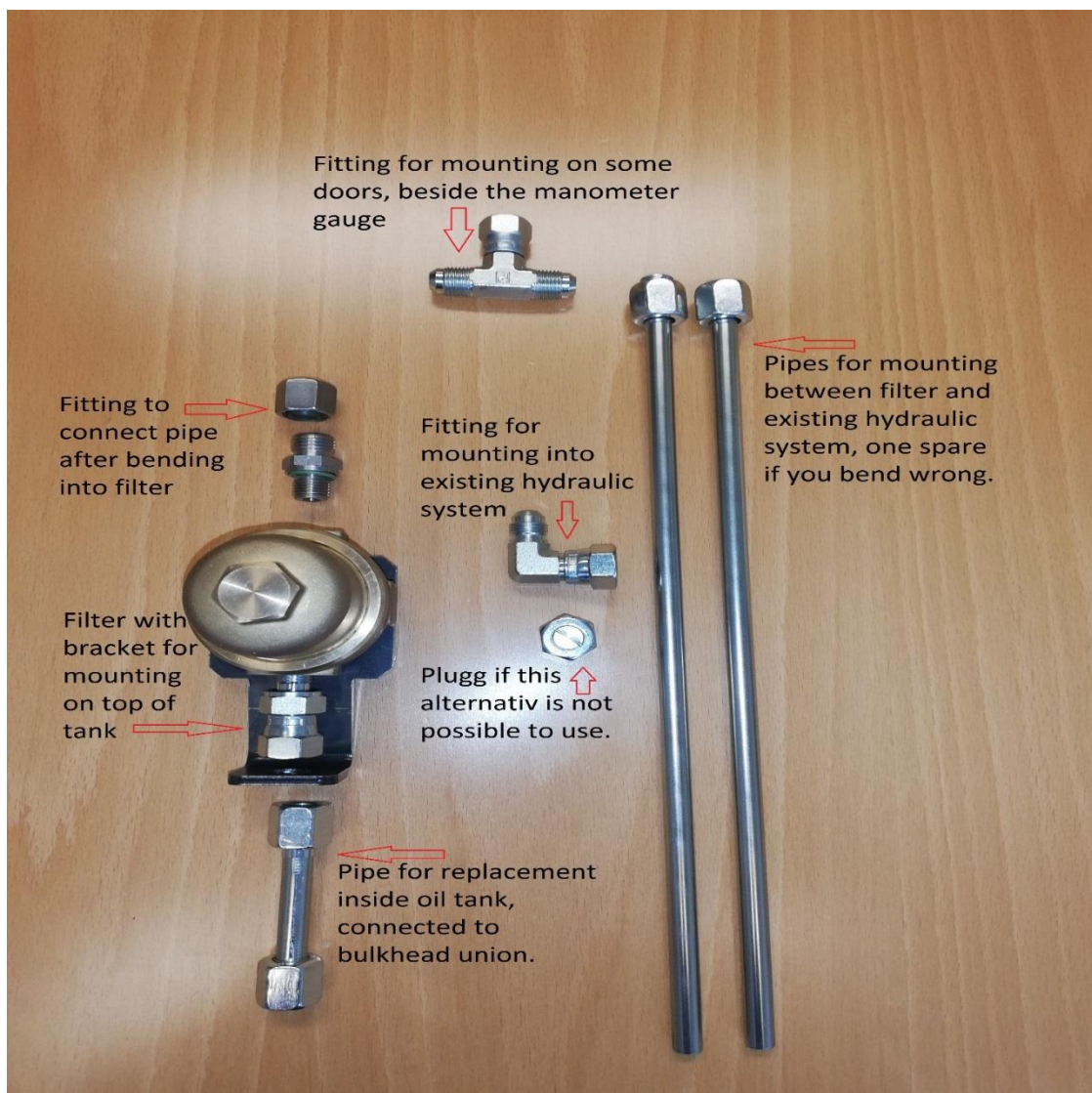

Picture 1 Rebuilding Kit

Date:	No:	Page:
04.04.2019	SB2019-06	2 of 3

Description:

- Before rebuilding the oil filter arrangement, the shutdown procedure as described in maintenance instruction MD.0709 has to be followed.
- Remove the old filter inside tank as below pictures.
- Some adjustments are needed to fit the new bracket and oil filter. Different fittings are included in the rebuilding set for different adjustments and possible mounting.
- The hydraulic tubing arrangement varies from different doors and projects. The new hydraulic tubing arrangement therefore must be evaluated depending on the actual arrangement in order to find the optimum solution
- It's recommended to replace the oil at the same time.
- Before switching the power to the hydraulic pump on, it's important to air the hand pump.



Picture 2 Remove the old filter and leave the nut on the pipe as shown on the right picture above



Picture 3 When fitting the new filter bracket to the bulkhead union, the pipe inside oil tank need to be replaced with slightly longer pipe

Date:	No:	Page:
04.04.2019	SB2019-06	3 of 3



Picture 4 Example of modified filter solution with new tubing arrangement

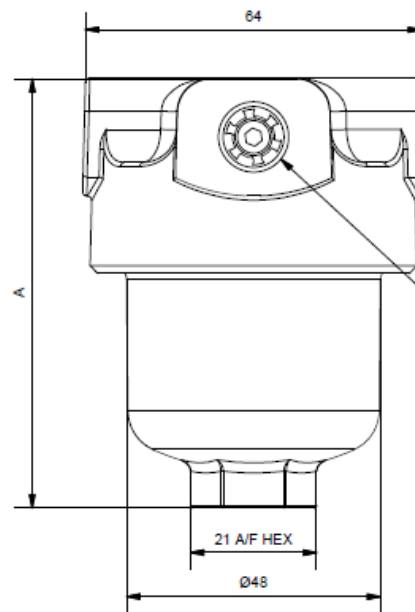

Length 1	A
	81

Please contact: spareparts@imstec.no